

fiora



PDD.FT.LINEA.TRAN4040.04_EN

Linea

SDTP4040



CSA B45.5
IAPMO/ANSI Z124



DIMENSIONS AND WEIGHT

Length: 40" (1016 mm)
Width: 40" (1016 mm)
Height: 1^{5/16}" (33 mm)
Weight: 111.3 lb (50.5 kg)

MATERIAL

Base: Silexpol® (matrix of mineral charges and polyurethane resin). Silica-free product.
Drain cover: Stainless steel, lacquered to match color of the base (brushed stainless steel finish optional).

TEXTURE

Slate.

COLORS

In stock:



0P
Total White



22T
Black



36T
Cappuccino



37T
Cement

On order:



0T
Off white



40T
Bone



41M
Silk grey



31T
Grey

INCLUDED

- Shower base.
- Drain cover.
- Tile flange (includes 2 long sides and 1 short side).
- Adhesive tape for sealing flange at the corners.
- Installation instructions and owner's manual.
- Packaged in a triplex carton box with a wood frame.

RECOMMENDED DRAINS (not included)

For 2" drain connection:

- Sioux Chief: 825-2 - PVC
- Oatey: 42049 - PVC
- Oatey: 42150 - BRASS
- Eastman: 15303 - PVC
- Zurn: FD2275
- OS&B SD35-CP - ABS
- OS&B SD5135-CP - PVC
- OS&B SD22 - BRASS

FEATURES

- Non slip finish: class III (Method of analysis: UNE-ENV 12633:2003).
- Nanobath: Bacteriostatic and fungistatic.
- Base can be cut on-site to accommodate room's architecture and measurements.
- Metalface: Extra coating to improve hardness and strength of shower base finish.
- Installation above floor or flush with the floor.
- Totally flat at the bottom.
- 100% waterproof, no membrane required.
- Easy installation using silicone/caulk or polyurethane adhesive.

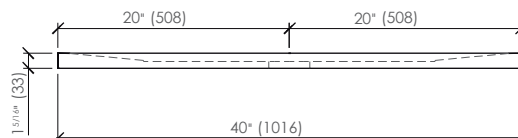
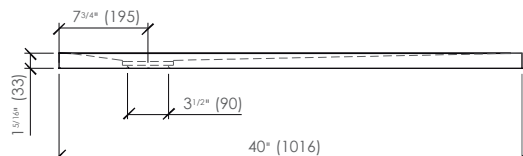
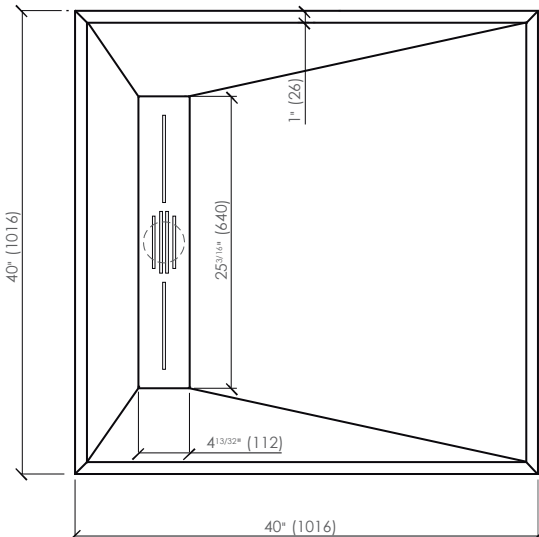

Approximate measurements. The manufacturer accepts 5 mm (0.2") variance. Products and specifications shown are subject to change without notice. Please contact AD Waters for any further inquiries, spare parts, etc.

Last revision 2024/04/23

www.fiora.us
Distributed by AD Waters
1-855-943-2782 (USA) / 1-800-660-4992 (Toronto)
1-800-867-8484 (Montreal) / 1-888-941-4411 (Vancouver)